



ALUMINCO[®]
ALUMINIUM BUILDING SYSTEMS

SL 2900

SLIDING
THERMAL
INSULATING
SYSTEM
FOR HYPER
PERFORMANCES





OUR NEXT GREAT GENERATION OF SLIDING SYSTEMS – AHEAD OF ITS TIME

The Aluminco SL2900 is a top performing sliding system with innovative and unique features, offering elegant constructions and satisfying large-scale requirements.

The art of minimal architectural design with first in class performance in terms of thermal insulation, air-and water-tightness, and the value-added SOFT CLOSE function, are some of the reference points that dominate and make the SL2900 unique.

This top-ranked system belongs to the new generation of architectural Aluminco systems, which are based on modern architectural trends, incorporating cutting-edge technology whilst offering unrivaled functionality, with unprecedented for its time performances.



SL 2900

ALUMINCO



PIONEERING DESIGN GRANTS FREEDOM

SL2900 is characterized by a unique innovative design, making freedom and elegance a way of life. The minimalistic look of the system is determined by the minimal profile face width in the centre section and an outer frame concealed in the attachment to the building structure while the fully integrated threshold option allows easy passage and maximizes user comfort.

- ▶ Maximum transparency and light penetration thanks to face width of 64 mm and the concealed, easy access outer frame.



HOTEL
SOLUTIONS

The ideal system for new constructions and hotel renovations.

SL 2900 meets all requirements for each hotel type and style, maximizing energy efficiency and reducing operation costs.





DESIGNED FOR HIGH PERFORMANCES

Aside from the design, the SL2900 is the only system that combines the ease of operation of lift-slide systems with the tight seal provided by tilt & slide elements. The latter is thanks to a continuous sealing system all around the perimeter, which saves large amounts of energy.

- ▶ Top level thermal insulation (U_f from $2.0 \text{ W/m}^2\text{K}$) thanks to the 24 mm reinforced polyamides.
- ▶ Exceptional performance in water and air tightness.
- ▶ Ability to use triple glazing for optimal sound reduction and maximum energy saving.

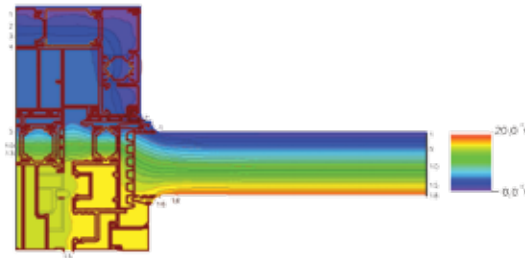

Rate of Insulation

$U_w=0.89 \text{ W/m}^2\text{K}$

Thermal conductivity coefficient has calculated for the construction:
5000x2500 with $U_g=0.5 \text{ W/m}^2\text{K}$
Glass type: 4/16 (ARGON) /4/16 (ARGON) /4
High Level Threshold





CUTTING EDGE TECHNOLOGY

Its unrivalled mechanisms, the integrated system of water drainage and the various versions of perimetric locking make SL2900 exceed the boundaries of an aluminium system perfectly expressing the art of well-being.

- ▶ SOFT CLOSE function
- ▶ Diversion mechanism
- ▶ Multiple perimetric locks
- ▶ Complete solution of water drainage

SL 2900

ALUMINCO





SOFT CLOSE FUNCTION

The use of a concealed mechanism, the SOFT CLOSE damper, turns SL 2900 into an exceptionally user friendly and safe system. Thanks to innovative SOFT CLOSE function the system's sash slows down during closing and guided reliably into the end position, minimising the risk of injury and of damage to the window elements.

- ▶ Rule out any risk of injury, protects the window elements and prevents damage to the building structure.
- ▶ Prevents damage caused by improper operation when opening or closing the slide sash and protects against any risk of injury.
- ▶ Simple and intuitive operation.
- ▶ Unique sliding feeling of the sash.
- ▶ High design standards due to concealed positioning.

SL 2900

ALUMINCO



DIVERSION MECHANISM

Smooth and easy operation of the system, even in demanding dimensions and robust constructions, is achieved through the unique diversion mechanism which guides the sash more gently and harmoniously into the locking position.

- ▶ Assures easy & smooth operation.
- ▶ Suitable for covering large openings, with a maximum height of 2.5 m and width of 5 m, retaining their functionality and credibility.
- ▶ The sliding hardware can reliably withstand sash weights of as much as 250 Kgr.

MULTIPLE PERIMETRIC LOCKS

SL 2900 follows a complete safety philosophy, which combines multiple perimetric locks for high security standards.

ALUMINCO

SL 2900





A COMPLETE SOLUTION FOR OPTIMISATION OF DRAINAGE

Every part of a top aluminium system needs to be perfectly combined in order to form a well balanced integrated structure. And the controlled drainage of water is no exception.

The excellent water tightness performance is achieved by using a specially designed profile incorporated as a trough under the system's track, allowing the water to flow through the high-quality plastic fittings straight into the drainage network.

In addition, the symmetrical holes on the profile facilitate and channel effectively the water in the rail's internal chamber, allowing its' easy and quick way out.



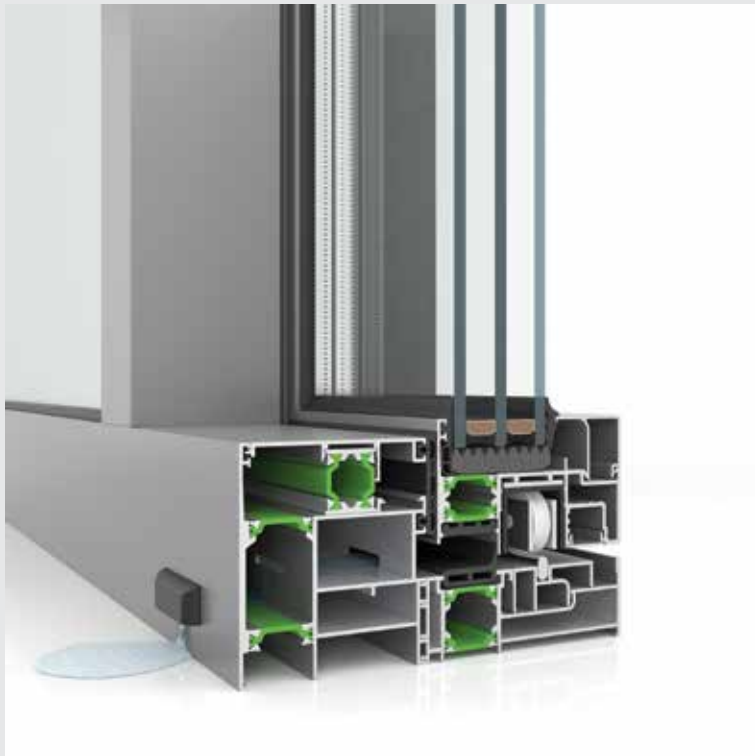

High Level Threshold

Threshold height: 86 mm

Threshold width: 170 mm



Upgrade Threshold

Threshold height: 33 mm

Threshold width: 170 mm



Fully Integrated Threshold

Threshold height: 75 mm
Threshold width: 173 mm

THREE DIFFERENT TRACK OPTIONS OFFER IDEAL SOLUTIONS DEPENDING ON OPERATIONAL NEEDS AND PERFORMANCE LEVELS

High Level Threshold

The high level threshold solution offers maximum performance meeting effectively even the most demanding needs.

Upgrade Threshold

The version of the upgrade rail is suitable for renovation constructions.

Fully Integrated Threshold

This version allows easy access and maximum comfort and in combination with the beauty of the non visible frame creates the optimal minimalistic appearance.

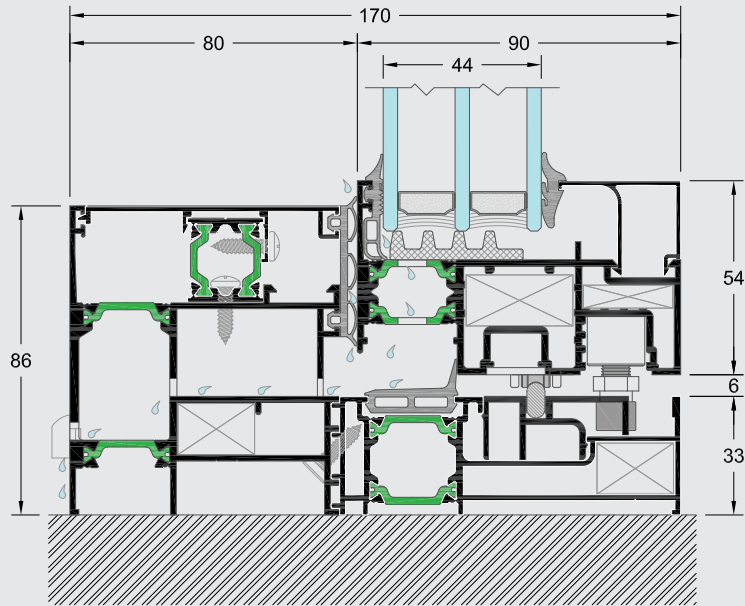

High Level Threshold

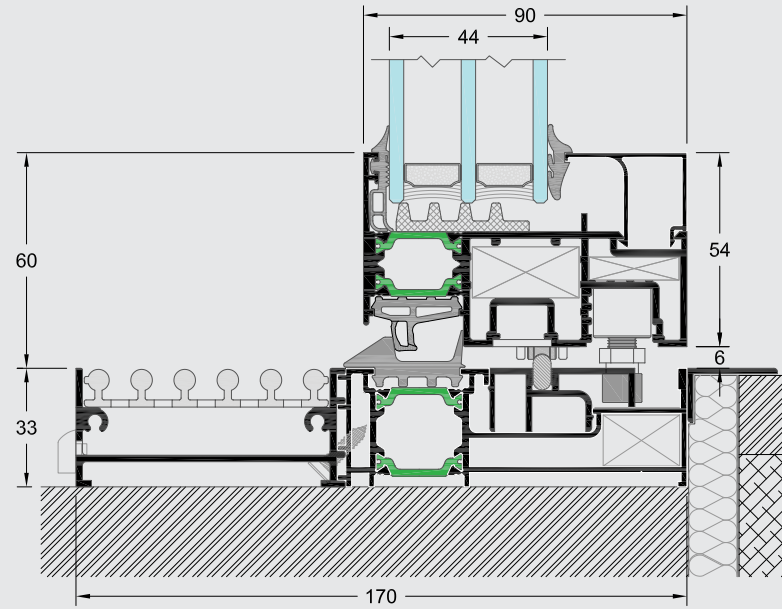

Upgrade Threshold

TECHNICAL CHARACTERISTICS

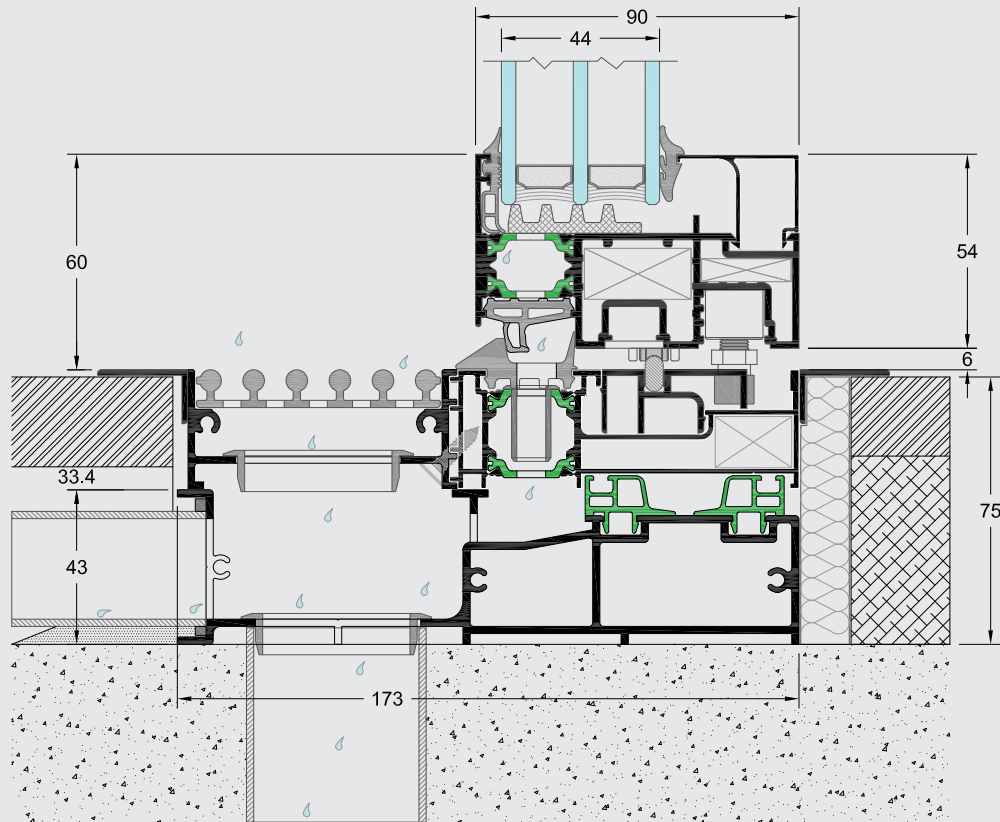

Fully Integrated Threshold

CONFIGURATIONS

1LEAF WITH FIXED, 2LEAF WITH FIXED

HARDWARE

SLIDING WITH DIVERSION

POLYAMIDES mm 20-24

SYSTEM PROFILE DIMENSIONS

MIN RAIL WIDTH mm 170
 MIN FRAME HEIGHT mm 86
 MIN FACE HEIGHT mm 54
 GLASS THICKNESS mm 44-74

CONSTRUCTION DIMENSIONS

SASH WIDTH mm 680-2500
 SASH HEIGHT mm 1200-2500
 MAX. SASH DIMENSIONS mm (WxH) 2500x2500
 MAX. SASH WEIGHT mm Kgr 250

PROFILE TECHNICAL CHARACTERISTICS

ALUMINIUM ALLOY AIMgSi 0.5 F22 (EN AW 6060)
 HARDNESS 12 Webster
 MIN PAINT THICKNESS 75 µm
 PROFILE THICKNESS 1.5-2.5 mm
 CHECK STANDARD EN DIN 12020-2

ALUMINCO[®]
ALUMINIUM BUILDING SYSTEMS

ALUMINIUM BUILDING SYSTEMS INDUSTRY

Inofita, Viotia GR-32011- Greece

T. +30 22620 47000

F. +30 22620 47090

www.aluminco.com

info@aluminco.com

SL 2900