



**SL160 – lift and slide doors
systems**

Description of the SL160 system



The functionality is provided by the way of opening – when you open the door, it does not occupy the internal space, it releases a big opening that allows to connect several rooms or a room with a street.

The increasing of **thermal parameters** of the system ($\geq 1\text{m}^2\cdot^{\circ}\text{C}/\text{W}$).

The increasing of **permissible parameters** according to the dimensions of the door $H = 3200$ (with reinforcing elements)

Description of the SL160 system



Frame SL160.0101

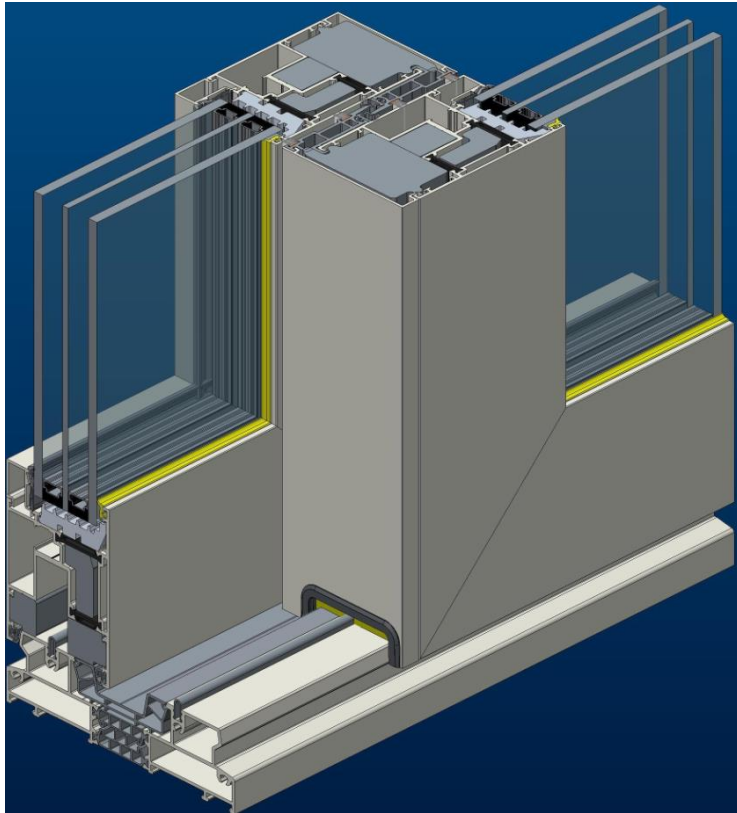

Double guiding rail doors

Frame SL160.0104

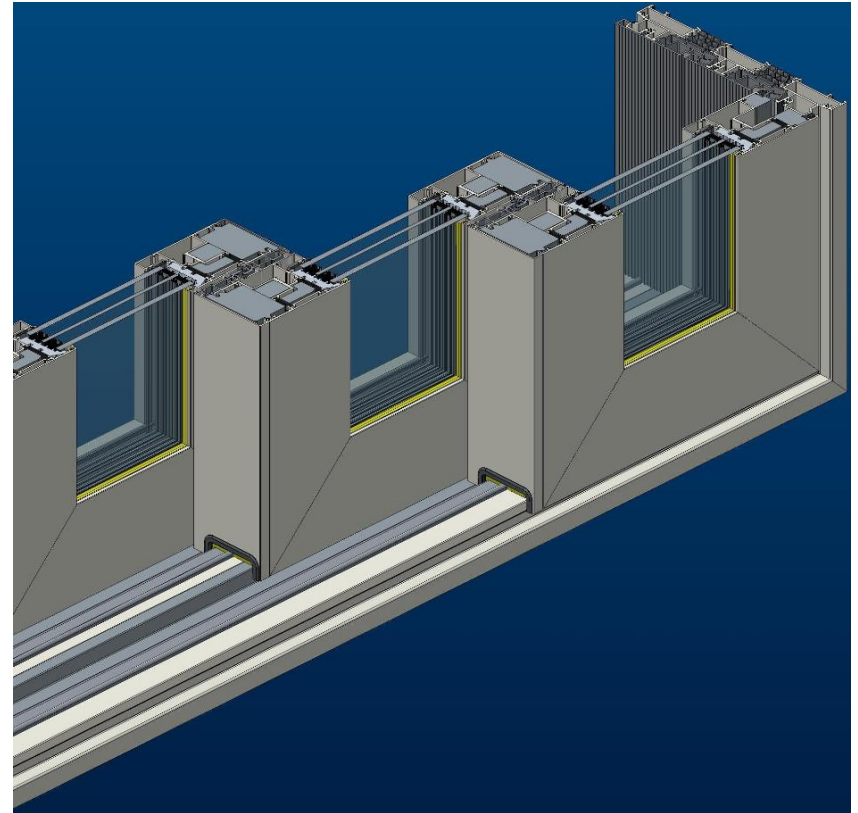

Triple guiding rail doors

Description of the SL160 system



Leaf to leaf connection is available for each leaf type SL160.0101, SL160.0102, SL160.0103 и SL160.0104

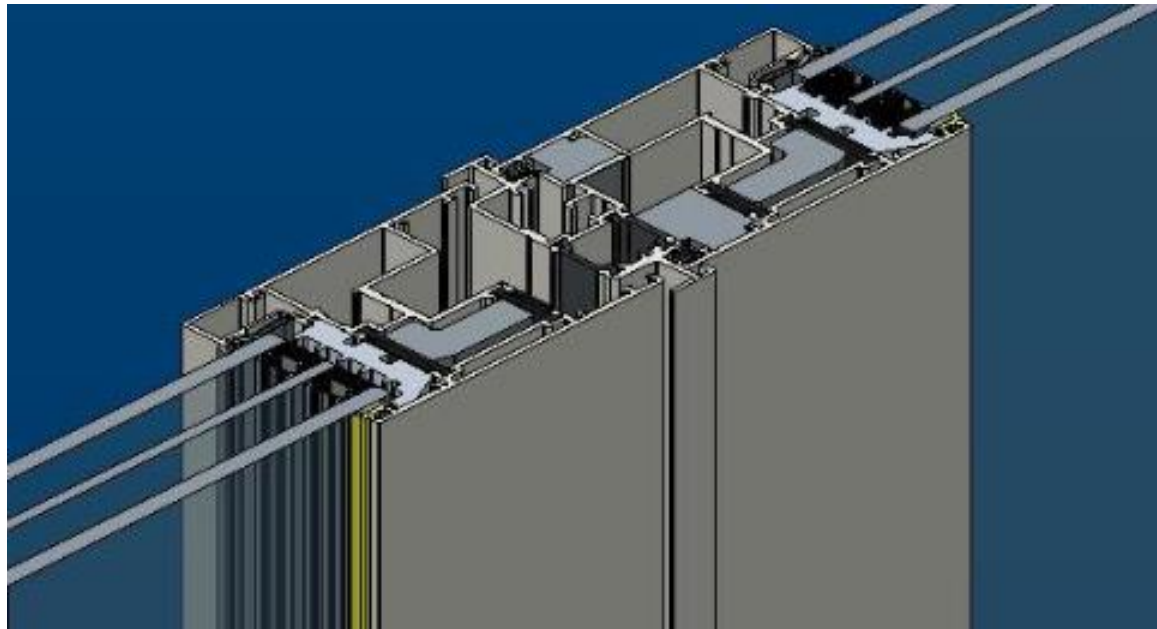

ALT SL160 opening options

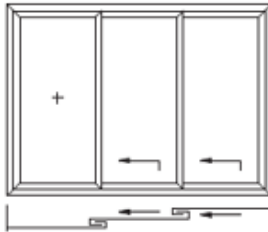
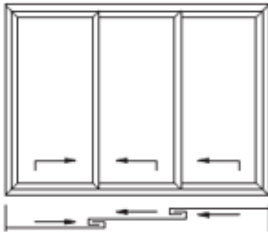
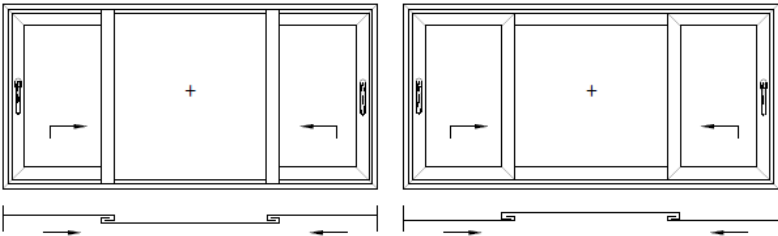
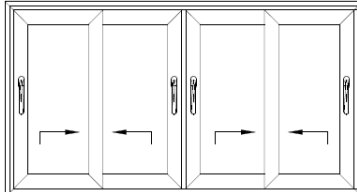
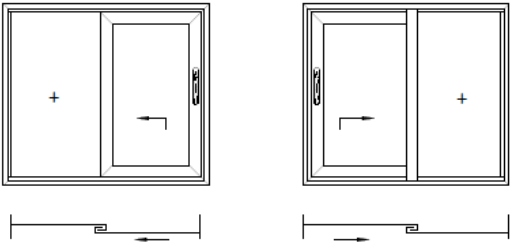
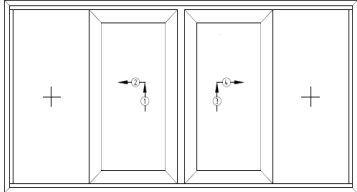
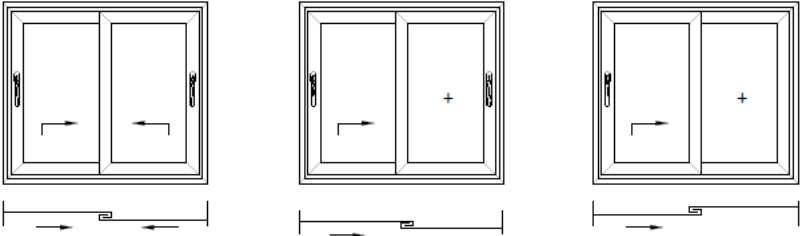

Rating	Performance	Rating	Performance
High level of noise resistance	up to 43 dB	Frame thickness	160 mm
Thermal conductivity, Uf	≤ 1W/m ² K	Sash thickness	72 mm
Air permeability	4-й класс	Maximum glass thickness	50 mm
Water penetration	600–750 Па (класс 9A)	Maximum Leaf weight	440 kg
Security level	WK2	Maximum Height	up to 3300 mm
Leaf weight for standard hardware set	up to 330 kg	Maximum width	up to 3200 mm
Hardware with reinforcement	(up to 440 kg)		

ALT SL160 Special solutions

Supporting and leveling thermal insulation profiles

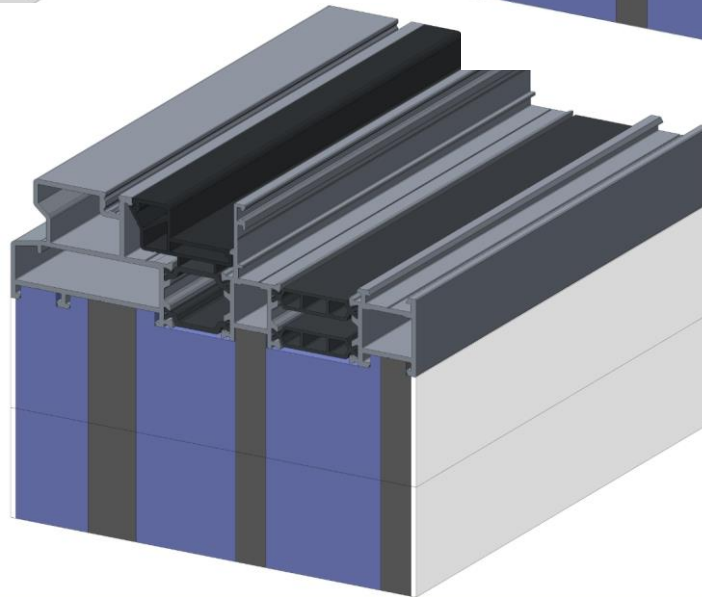
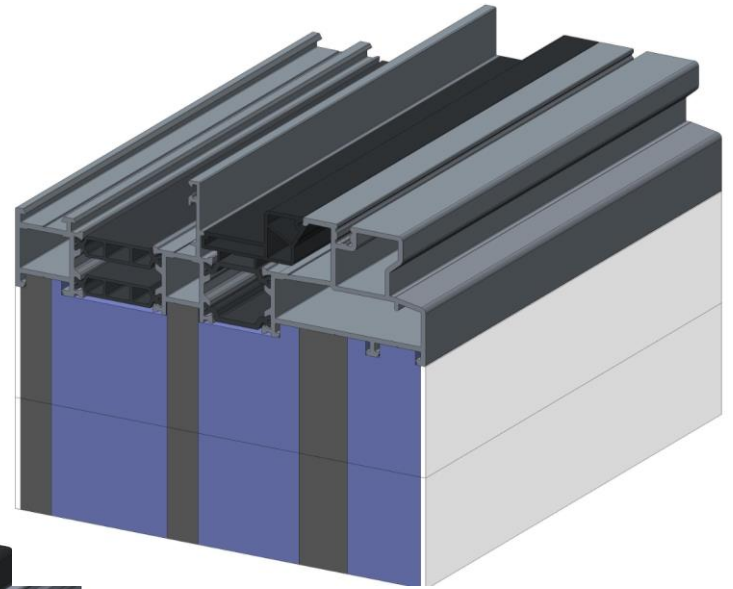
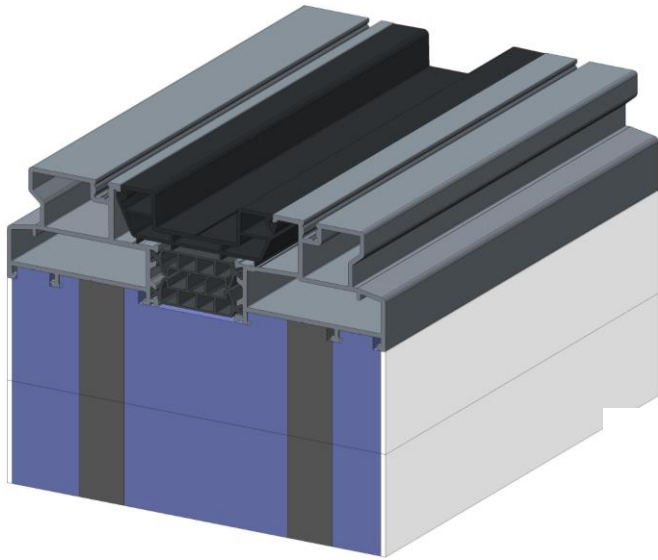

ALT SL160 special solutions

Leaf weight up to 440 kg

Comfort Close

Comfort Drive



ALT SL160 adavantages

Modern design

High dimension leaves and maximum transparency

High thermal insulation performance ($U_w \leq 1\text{W/m}^2\text{K}$)

Anti-Bmetal thermal break allows to compensate thermal deformation and prolong the durability of the system in every region



Secured by designed Pas 24

